

Copper-Mate Endmill

Copper, Bronze and Non-ferrous materials

Characteristics

- Suitable for Copper, Bronze and Non-ferrous materials
- Ball, Radius type



Features

- Cutting edge considered the characteristics of non-ferrous materials
- CrN coating for enhanced oxidation resistance and corrosion resistance

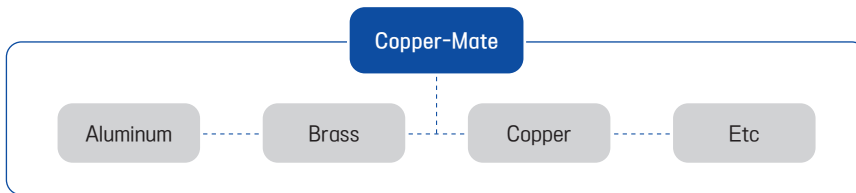
Applications



Contents

Section		Geometry	Geometry	Product	Diameter(DC)		Page
Shape	Flute				Min	Max	
Radius	2F	RC502		2 Flutes Radius End Mill	2	12	395
Ball	2F	BC502		2 Flutes Ball End Mill	1	12	396

EDP No. System

*If expressed as an integer, the decimal point is omitted.



①	②	③	④	⑤	⑥	⑦	⑧
Appearance	Shape	Grade	Length, Shank Type	Flutes	Cutting Dia	Corner R	Shank Dia
R : Radius B : Ball	C : Copper	5 : Grade	0 : Neck	2 : 2 Flutes	1 ~ 12	0.5 ~ 1	3 ~ 38

EX) 2 Flutes / Cutting Dia \varnothing 2 / Corner R 0.5 / Shank Dia 9 / 50 Grade / Corner Radius Neck Type Radius End Mill

RC502 2 Flutes Radius End Mill

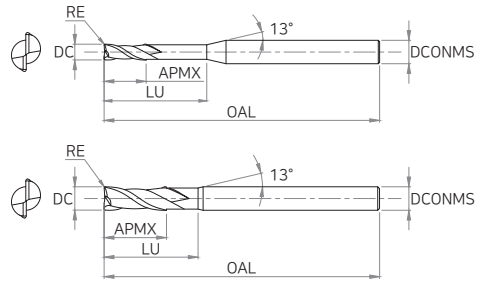

► Tolerance

DC		Shank Dia
ø2 ~ ø6	0 ~ -0.012	
ø8 ~ ø12	0 ~ -0.015	

h5

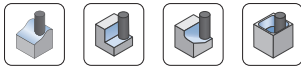

EDP No	DC	RE	APMX	LU	OAL	DCONMS
RC502 0200509	2	0.5	3	9	55	6
RC502 0300509	3	0.5	4	9	55	6
RC502 0305016	3	0.5	4	16	55	6
RC502 0305020	3	0.5	4	20	55	6
RC502 0400512	4	0.5	5	12	55	6
RC502 0400516	4	0.5	5	16	55	6
RC502 0400520	4	0.5	5	20	55	6
RC502 0600520	6	0.5	7	20	60	6
RC502 0601020	6	1	7	20	60	6
RC502 0800525	8	0.5	9	25	60	8
RC502 0801025	8	1	9	25	60	8
RC502 1000532	10	0.5	11	32	70	10
RC502 1001032	10	1	11	32	70	10
RC502 1200538	12	0.5	12	38	80	12
RC502 1201038	12	1	12	38	80	12

► Applicable Working Material

○ : GOOD ◎ : EXCELLENT

H		P			K	N			M	S
Hardened Steel		Carbon Steel	Alloy Steel	Prehardened Steel	Cast Iron	Copper	Graphite	Aluminum	Stainless Steel	Heat Resistant Alloy
SKD61 ~HRc55	SKD11 HRc55~	Carbon Steel ~HB225	Alloy Steel HB225 ~325	Prehardened Steel HRc30~50	Cast Iron ~FCD500	○		○		

Endmill

Zamus Star

E-Star

U-Wing

Zamus Thunder

X-Star

S-Wing

A-Wing

Standard

Copper-Mate

Gra-Mate

BC502 2 Flutes Ball End Mill

Endmill

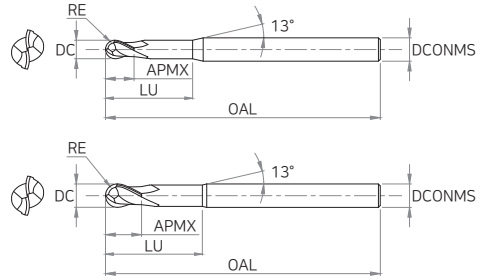

► Tolerance

DC		Shank Dia
All Sizes	0 ~ -0.02	h6

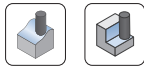

CARBIDE
CrN
2
30° HELIX
R ±0.01
DATA P.736

All Sizes

EDP No	DC	RE	APMX	LU	OAL	DCONMS
BC502 010	1	0.5	1.5	3	50	6
BC502 015	1.5	0.75	2	4	50	6
BC502 020	2	1	2.5	5	50	6
BC502 025	2.5	1.25	3	7	50	6
BC502 030	3	1.5	4	10	60	6
BC502 040	4	2	5	10	60	6
BC502 050	5	2.5	6	12	60	6
BC502 060	6	3	7	12	60	6
BC502 061	6	3	7	12	90	6
BC502 080	8	4	9	15	70	8
BC502 081	8	4	9	16	100	8
BC502 100	10	5	11	25	75	10
BC502 101	10	5	11	25	100	10
BC502 120	12	6	12	25	80	12
BC502 121	12	6	12	25	110	12

Copper-Mate

Gra-Mate

► Applicable Working Material

○ : GOOD ◎ : EXCELLENT

H		P			K	N			M	S
Hardened Steel		Carbon Steel	Alloy Steel	Prehardened Steel	Cast Iron	Copper	Graphite	Aluminum	Stainless Steel	Heat Resistant Alloy
SKD61 ~HRc55	SKD11 HRc55~	~HB225	HB225 ~325	HRc30~50	~FCD500					
		○	○			○		○		